

...NI DI MONTAGGIO
SYNTHESIS LINE MONACO SP. 1118

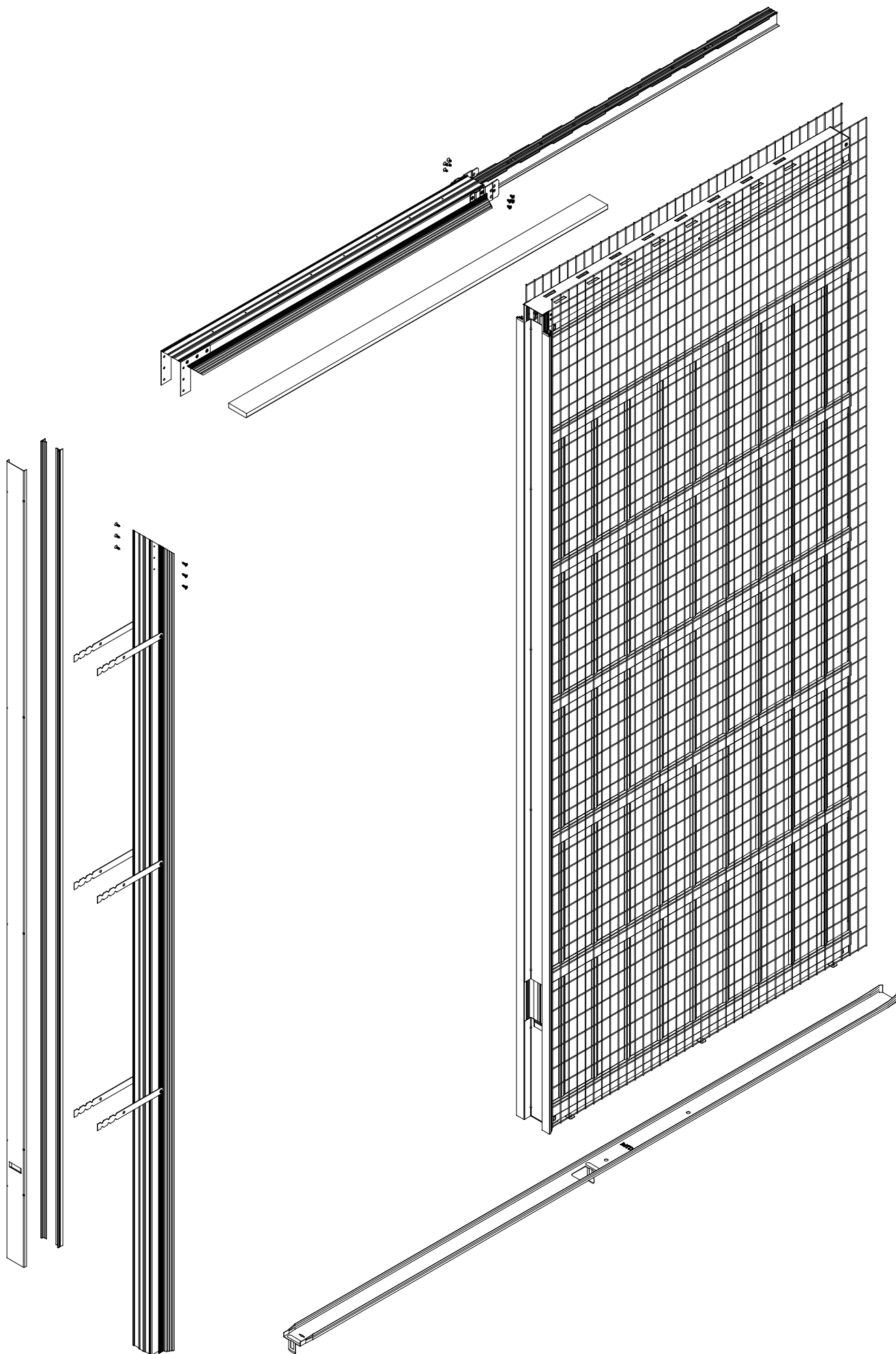



ESPLOSO

AFL 4,2 x 9,5 TC ZNB

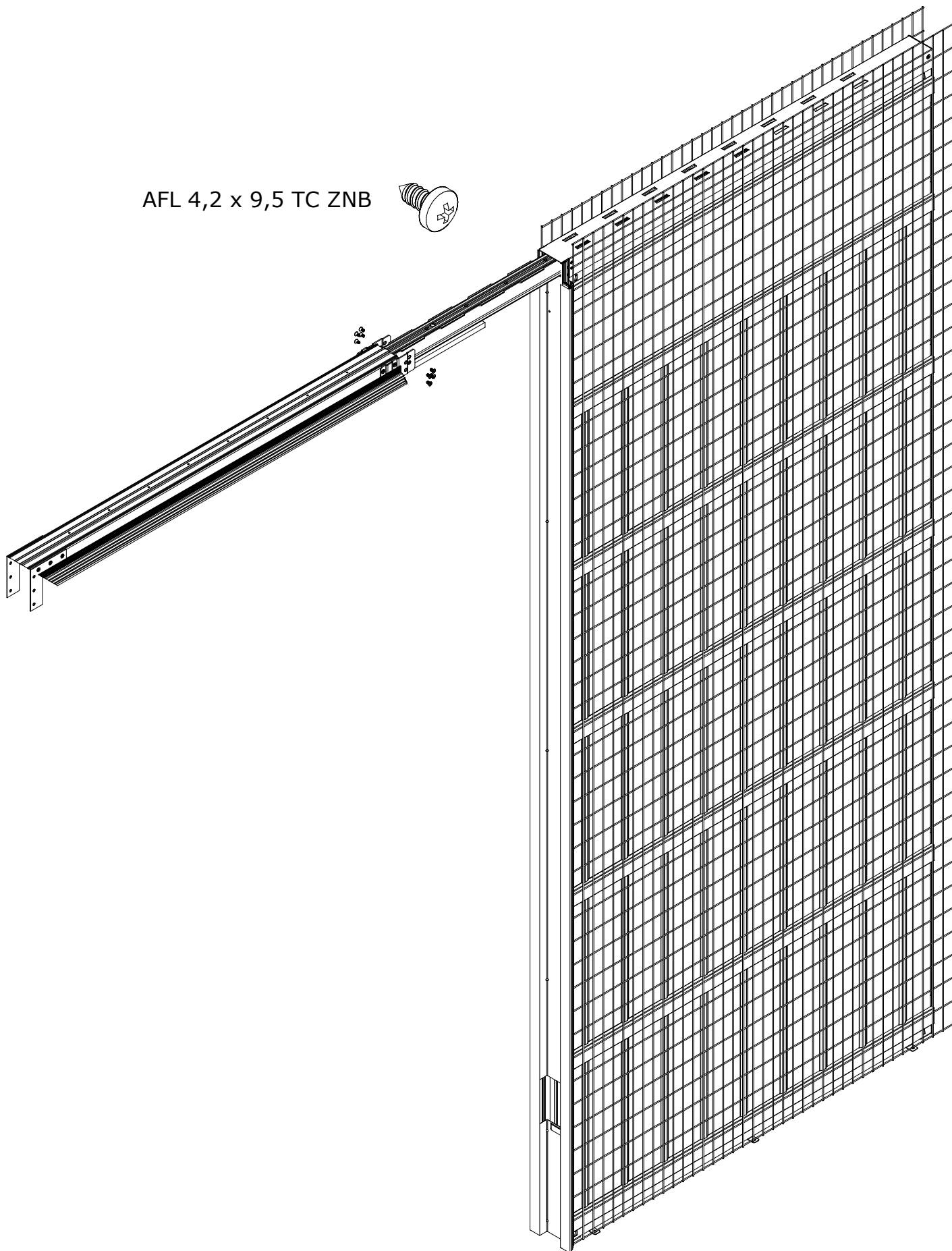

INSERIMENTO TRAVERSA +
BINARIO SU CASSONE

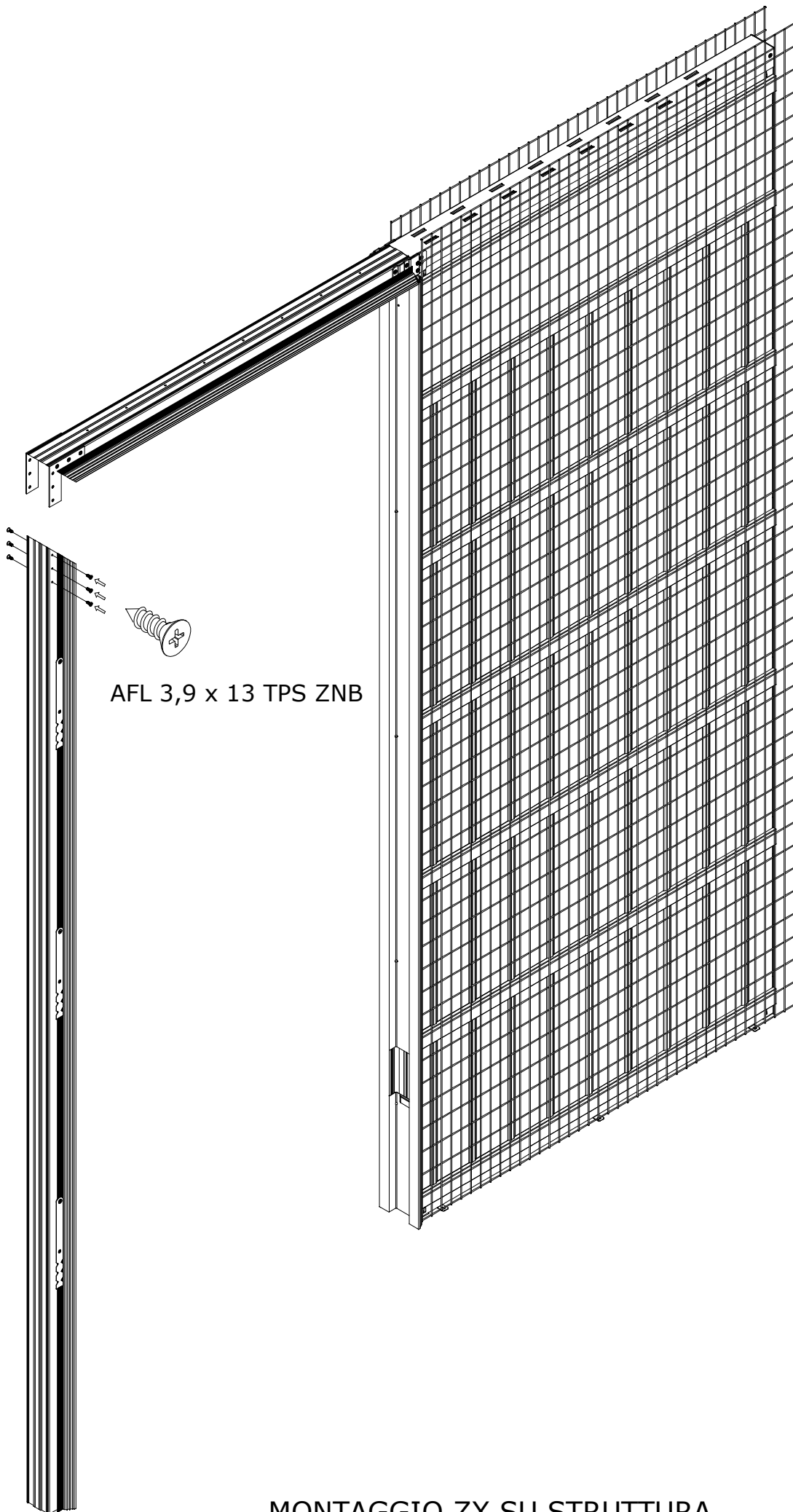

AFL 3,9 x 13 TPS ZNB

MONTAGGIO ZX SU STRUTTURA

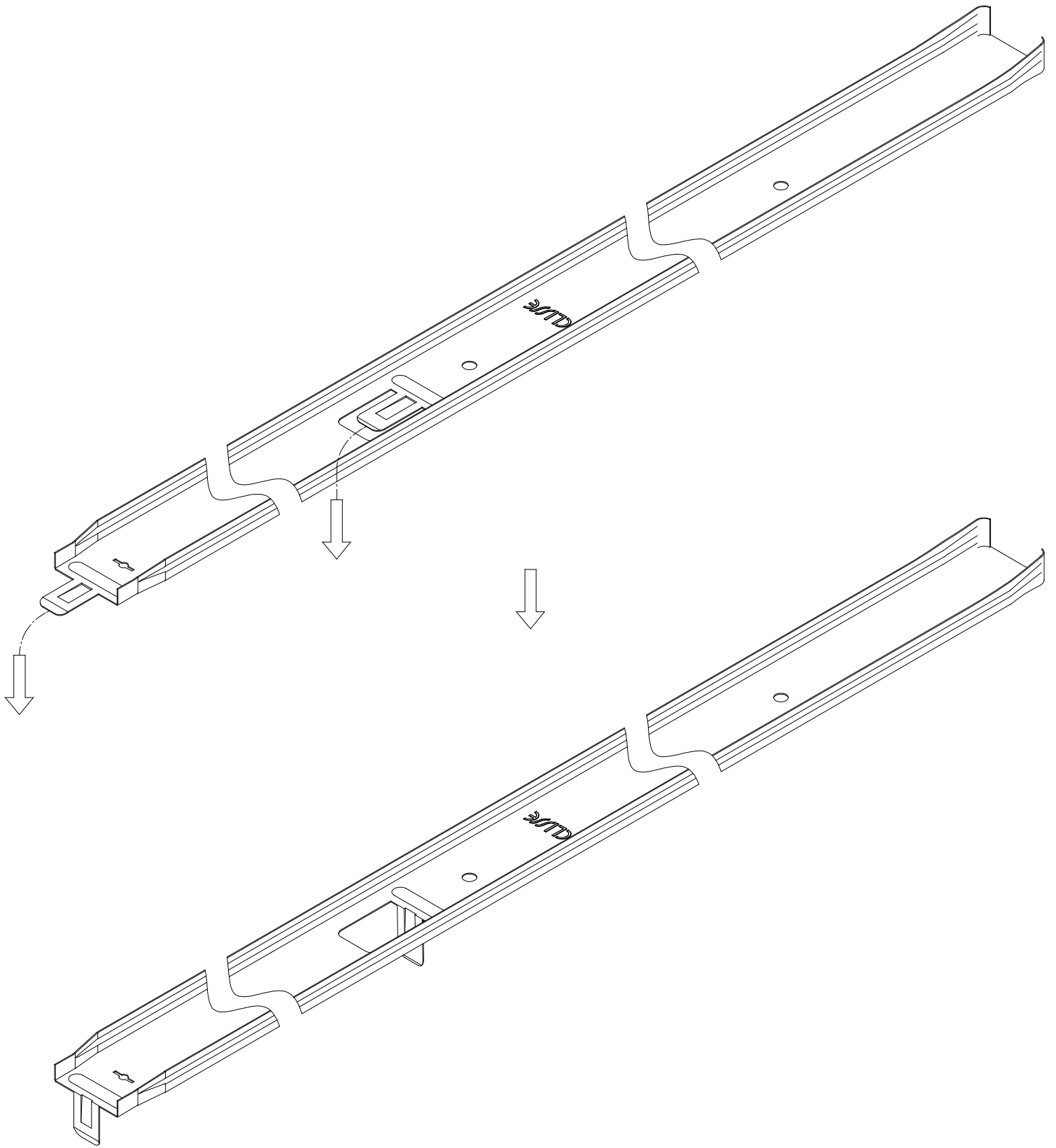

PIEGATURA LEMBI BARRA DI ALLINEAMENTO

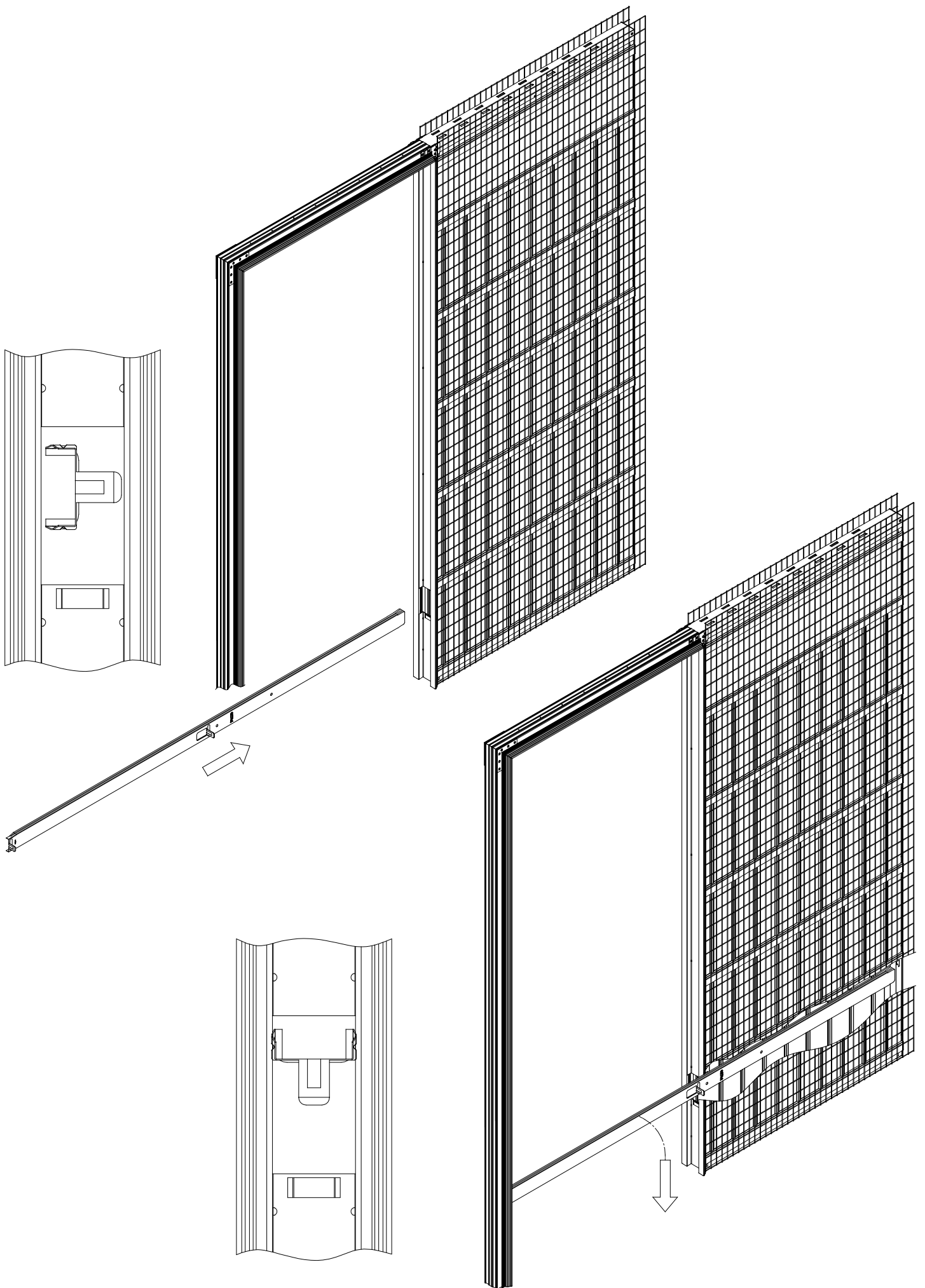

MONTAGGIO BARRA DI ALLINEAMENTO

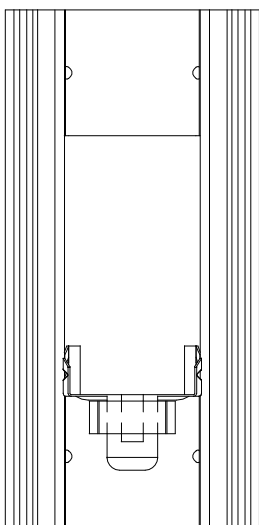
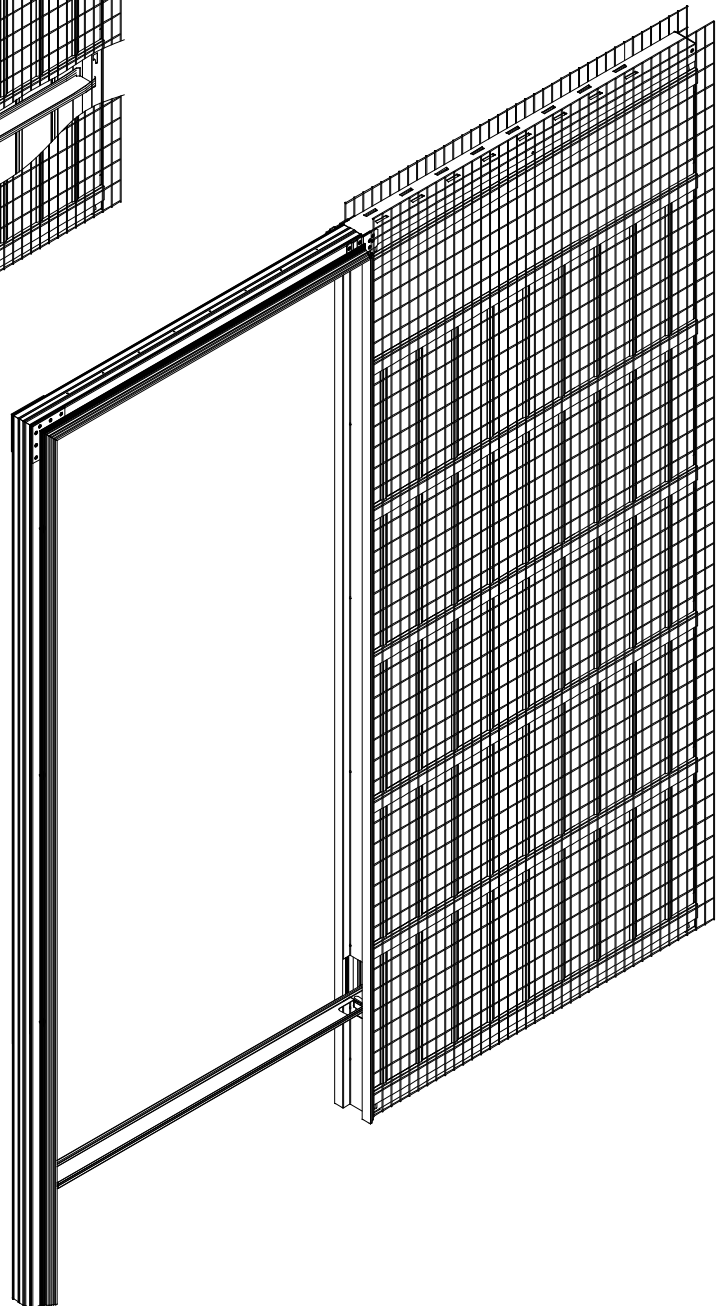
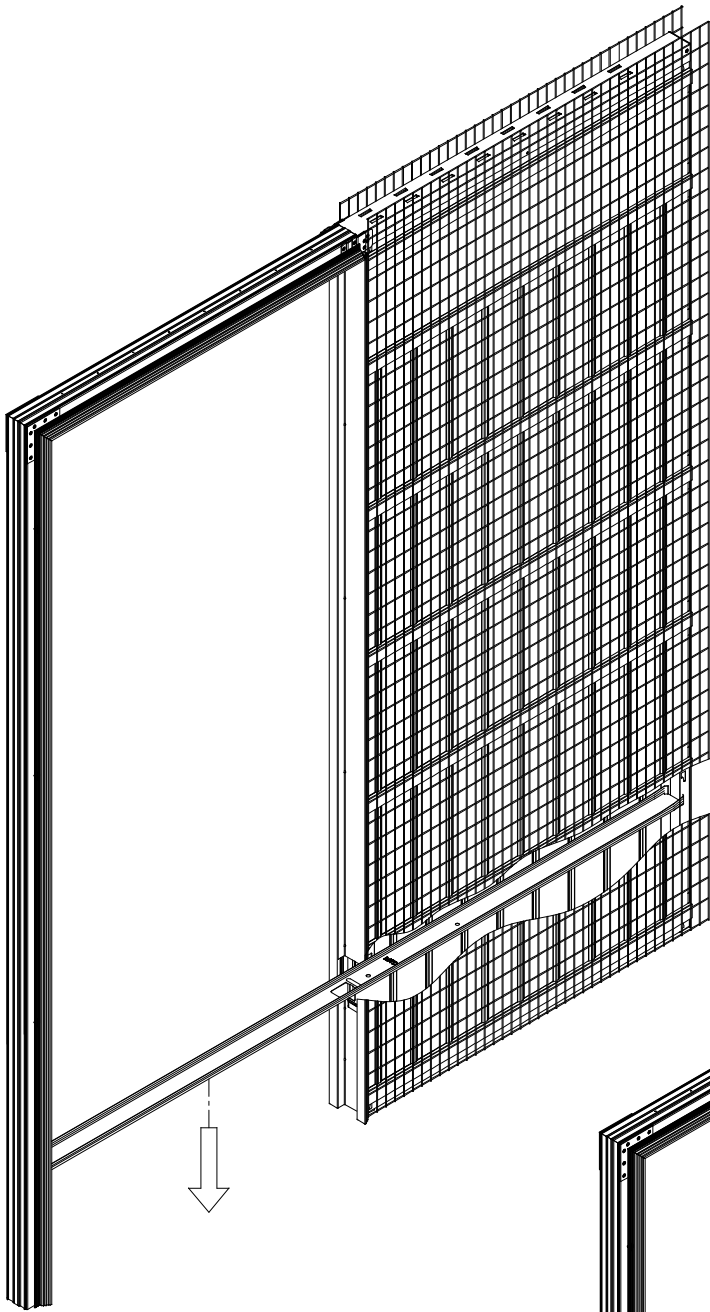

MONTAGGIO BARRA DI ALLINEAMENTO

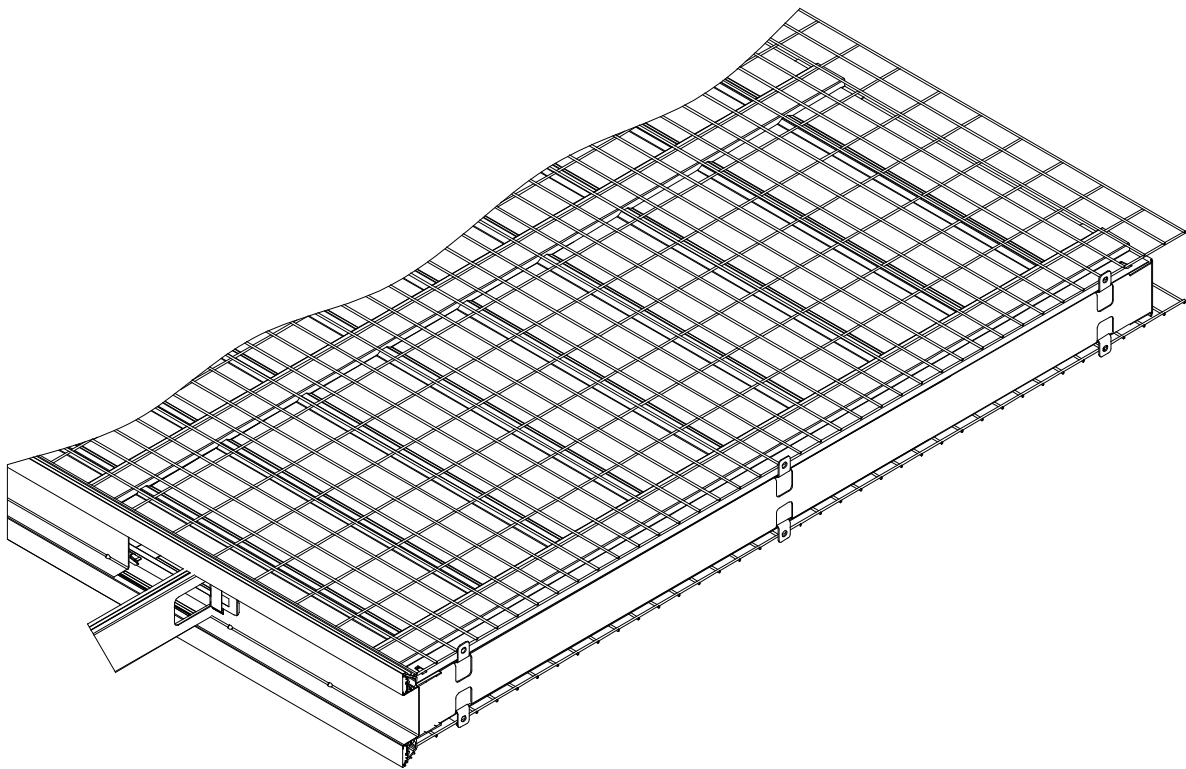
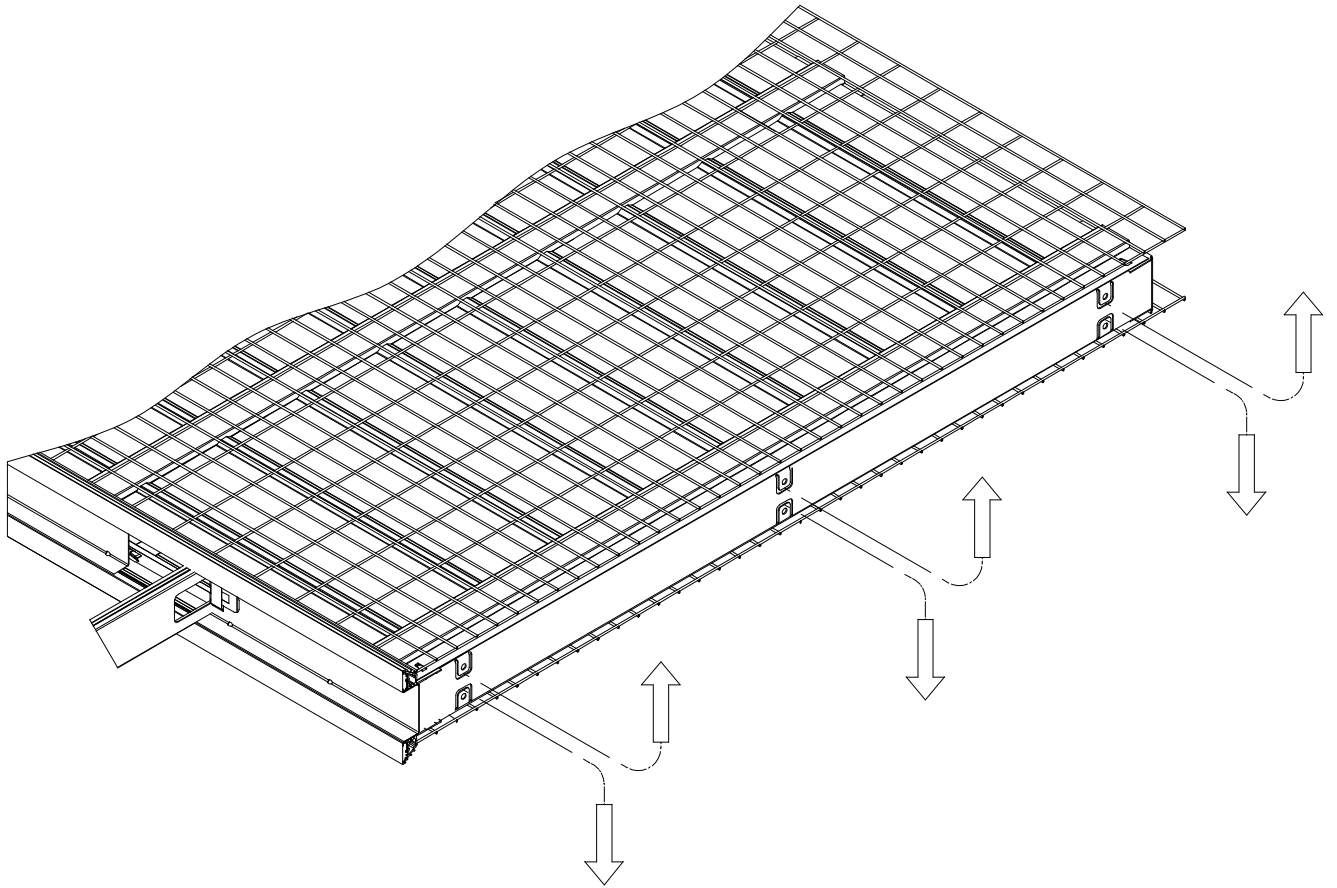

PIEGATURA LEMBI SOTTOPORTA

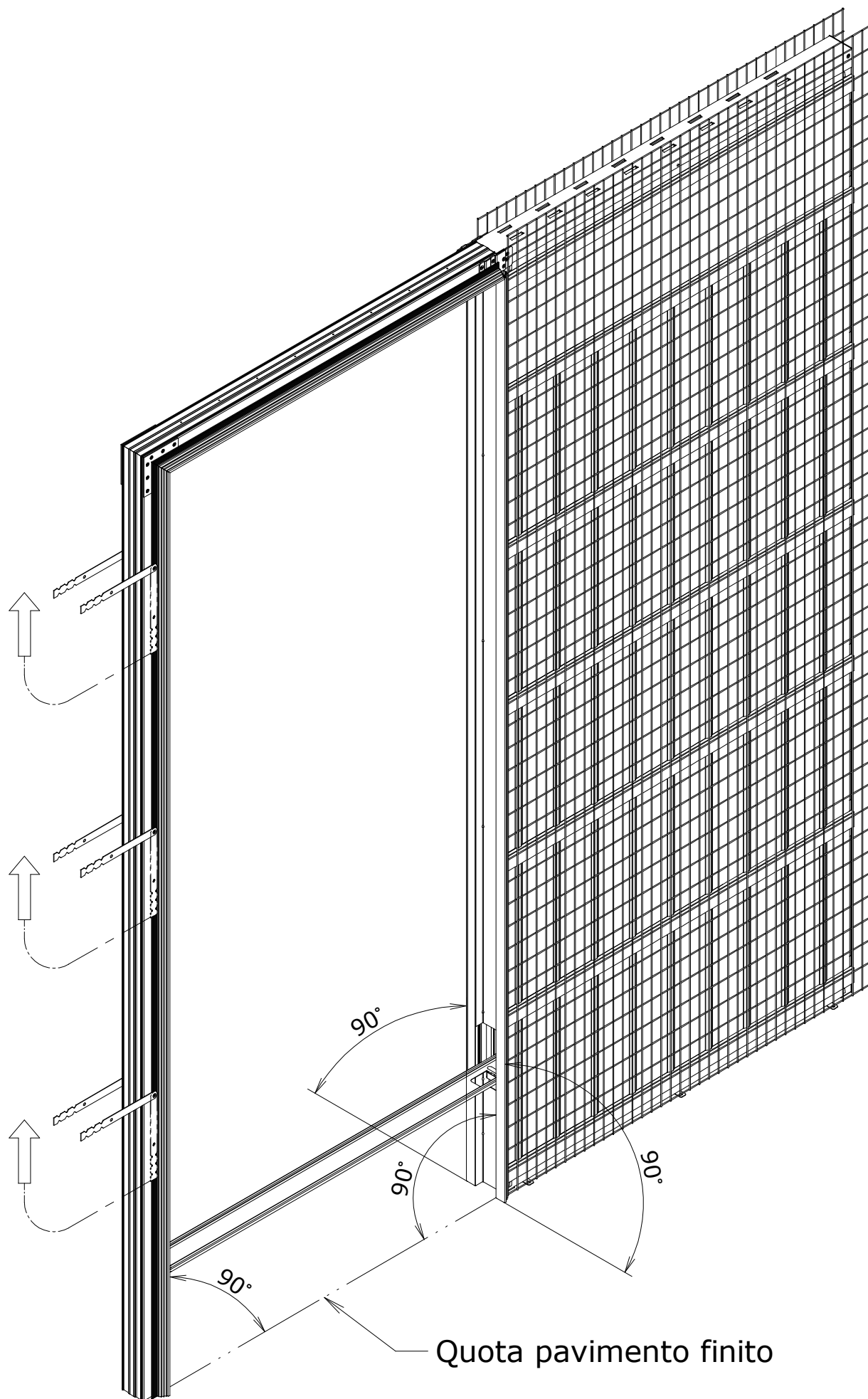

POSIZIONAMENTO ZANCHE

Importante: per non caricare la struttura si deve usare un travetto che non deve appoggiare direttamente sul controtelaio.

COME INTONACARE

Il controtelaio è una struttura metallica che, integrata a materiali inerti, va a formare un'unica parete. Poiché tale struttura è soggetta a vibrazioni, per evitare l'insorgere di fessurazioni, la preparazione dell'intonaco deve essere oggetto di particolare attenzione.

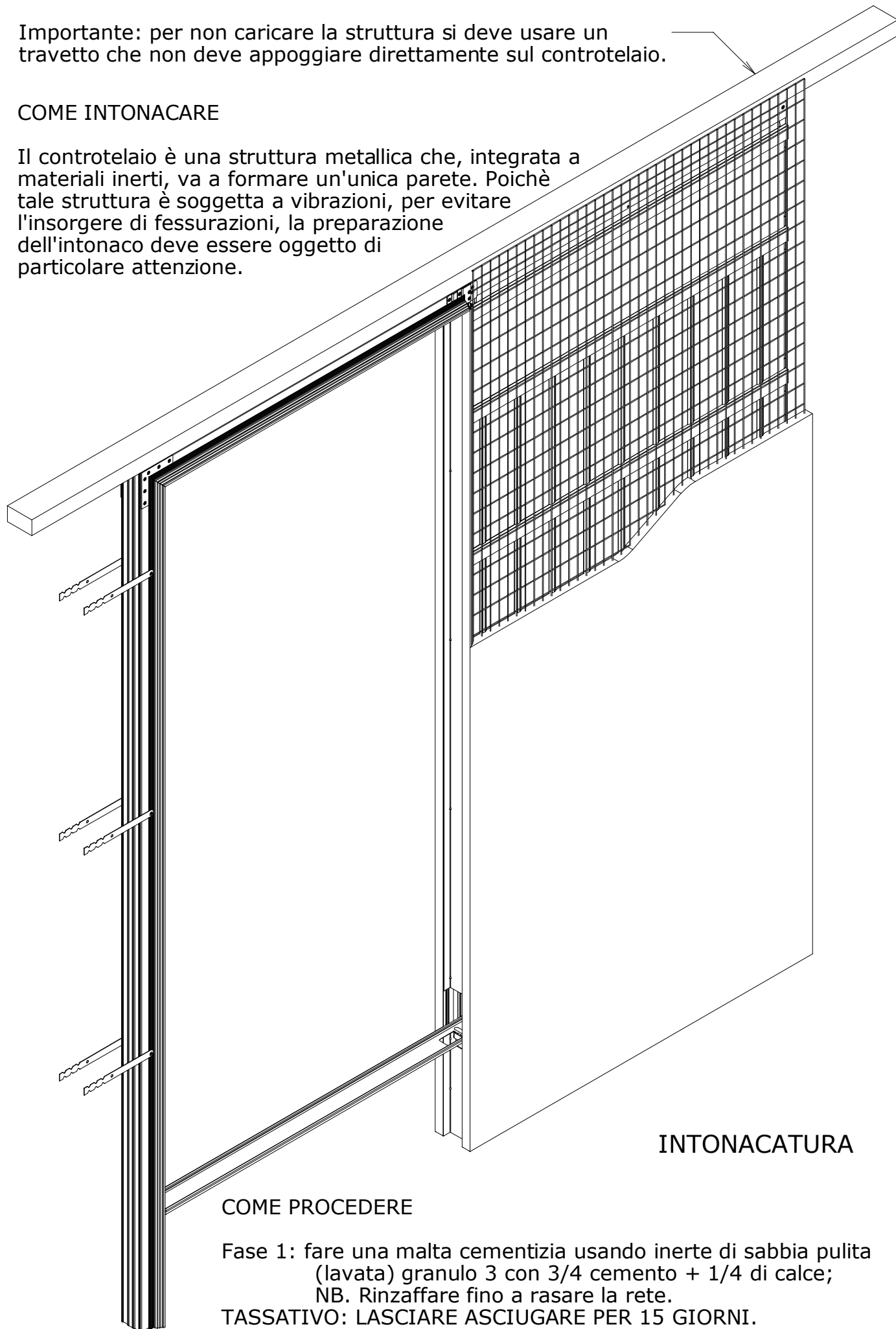

COME PROCEDERE

Fase 1: fare una malta cementizia usando inerte di sabbia pulita (lavata) granulo 3 con 3/4 cemento + 1/4 di calce;
NB. Rinzaffare fino a rasare la rete.

TASSATIVO: LASCIARE ASCIUGARE PER 15 GIORNI.

Fase 2: applicare la successiva mano di intonaco per finitura con un impasto tradizionale.

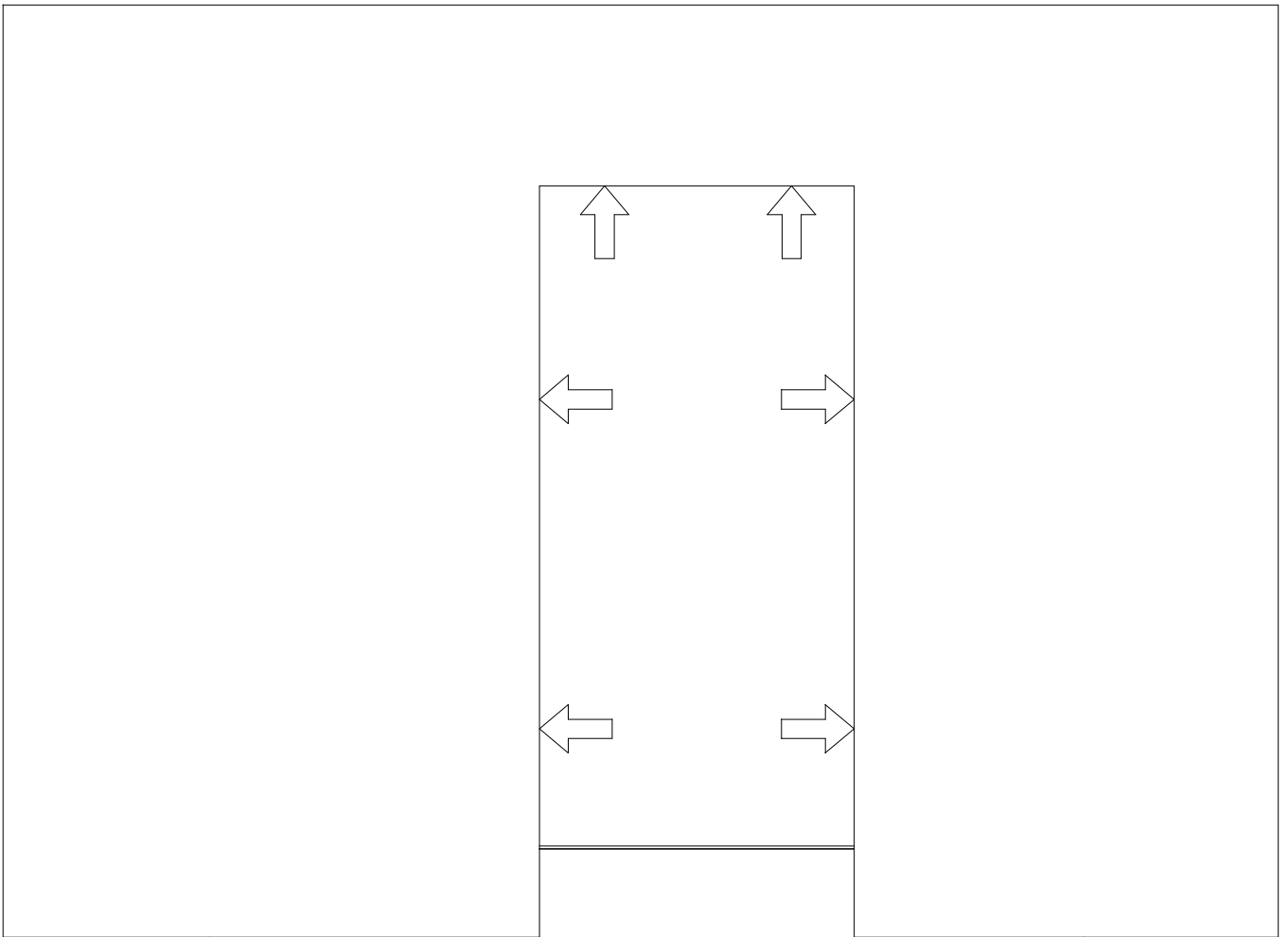
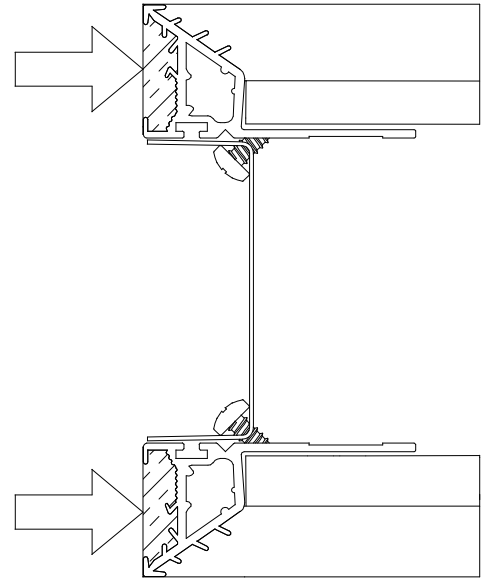
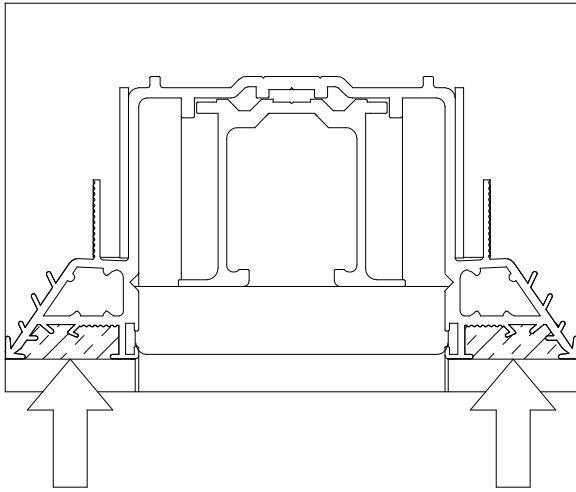

APPLICAZIONE STUCCO O SCAIOLA

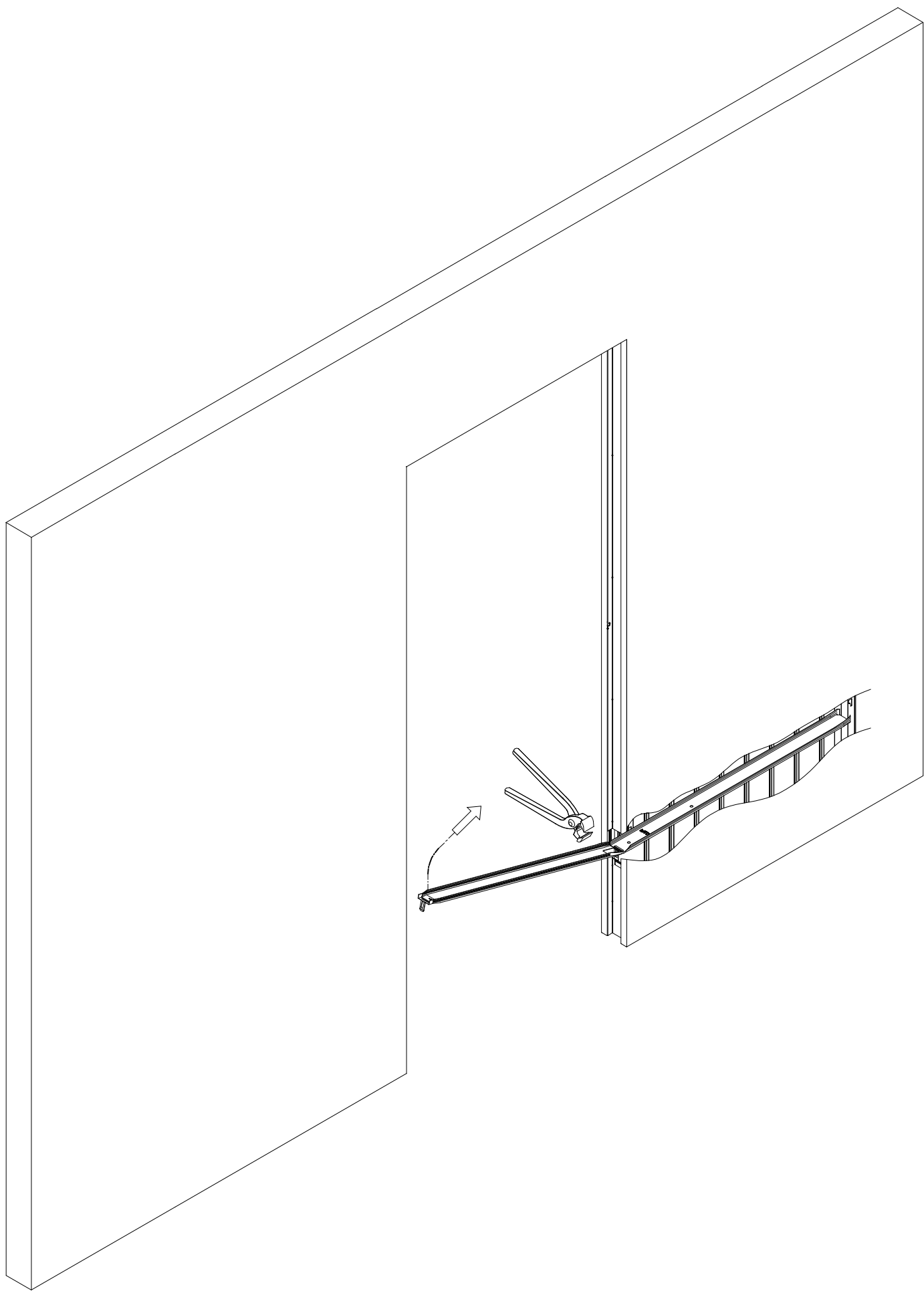

SMONTAGGIO BARRA DI ALLINEAMENTO

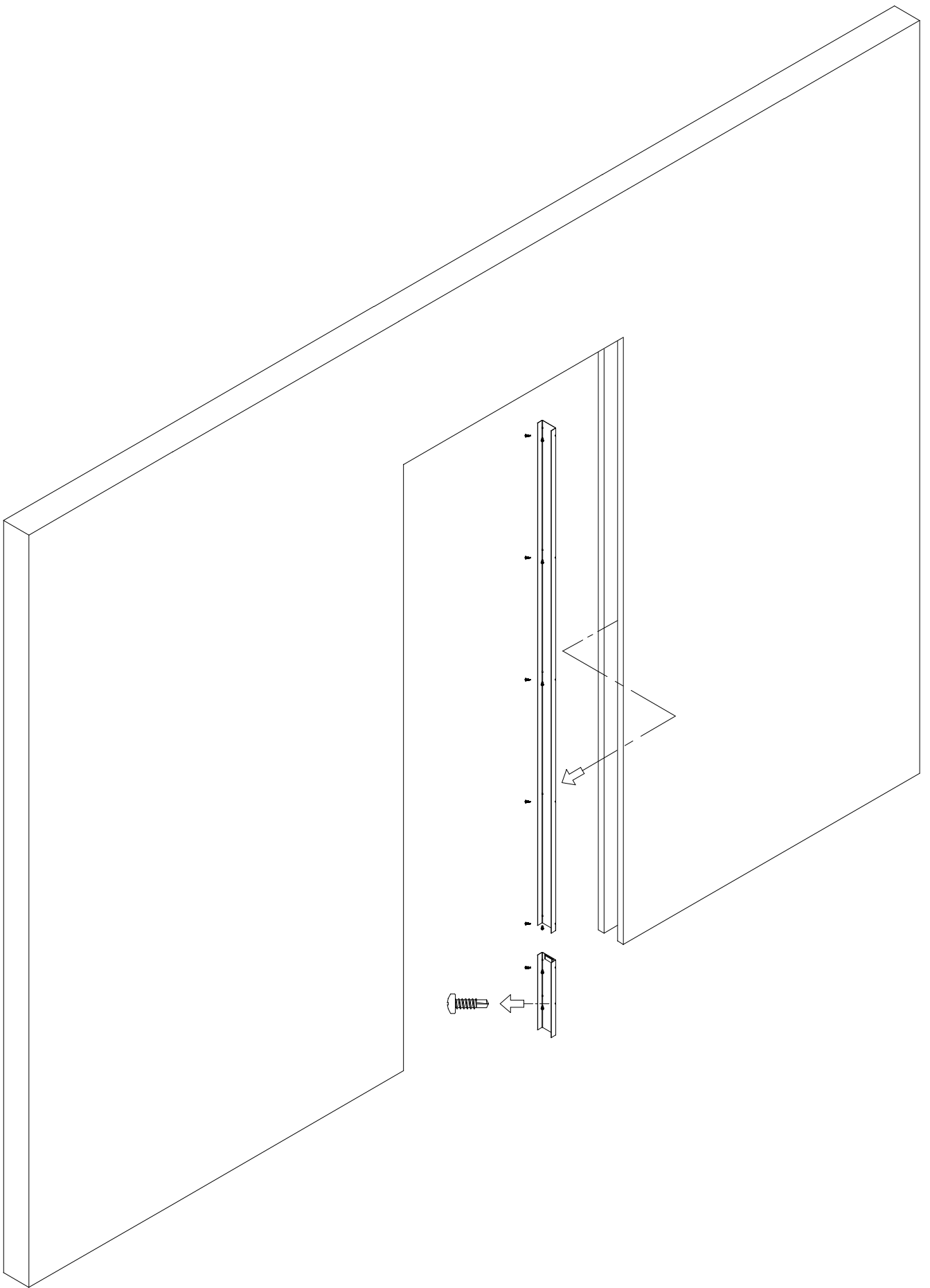

SMONTAGGIO FRONTALINI CASSONE

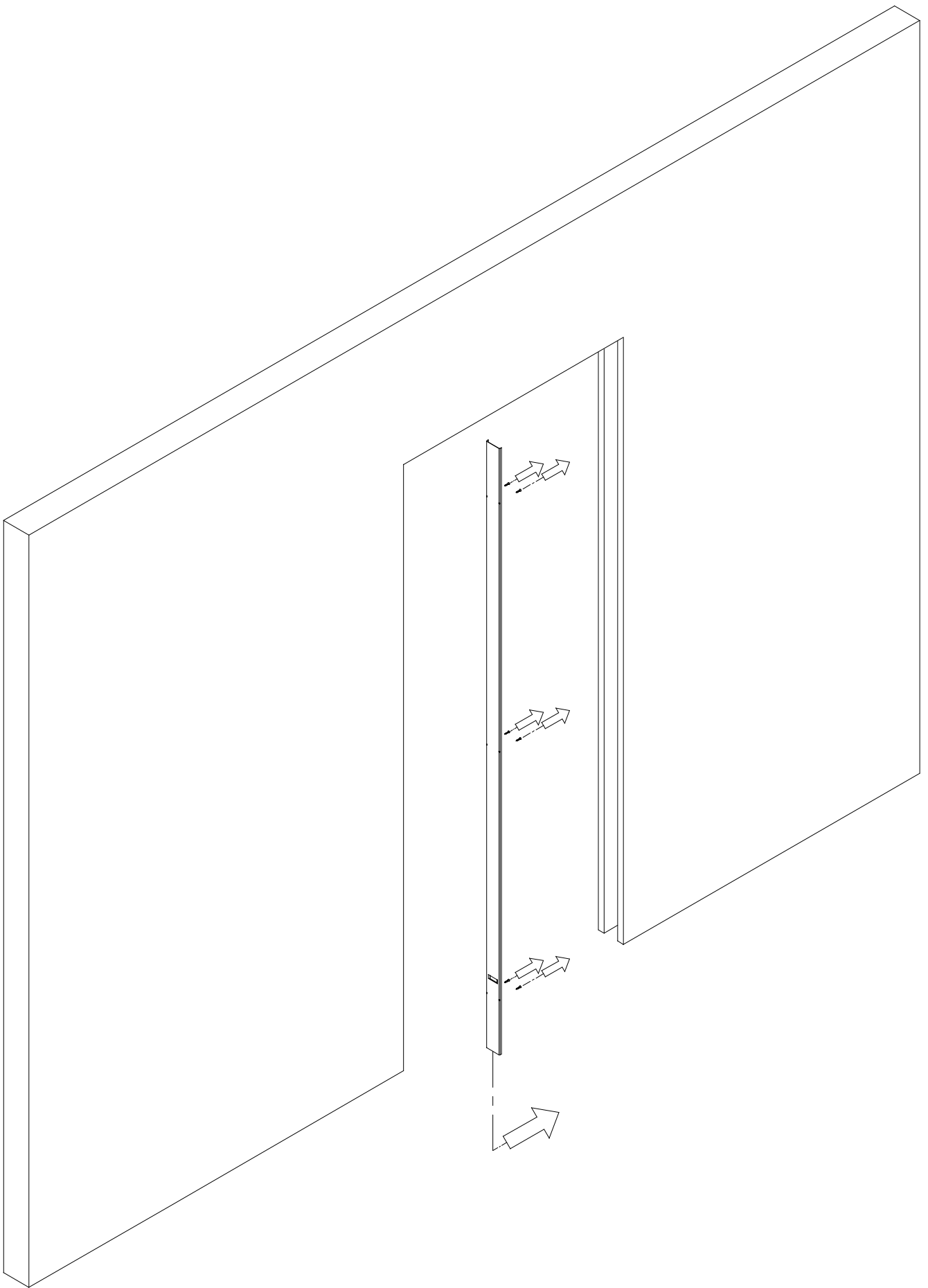

SMONTAGGIO PROTEZIONE CASSA DI BATTUTA

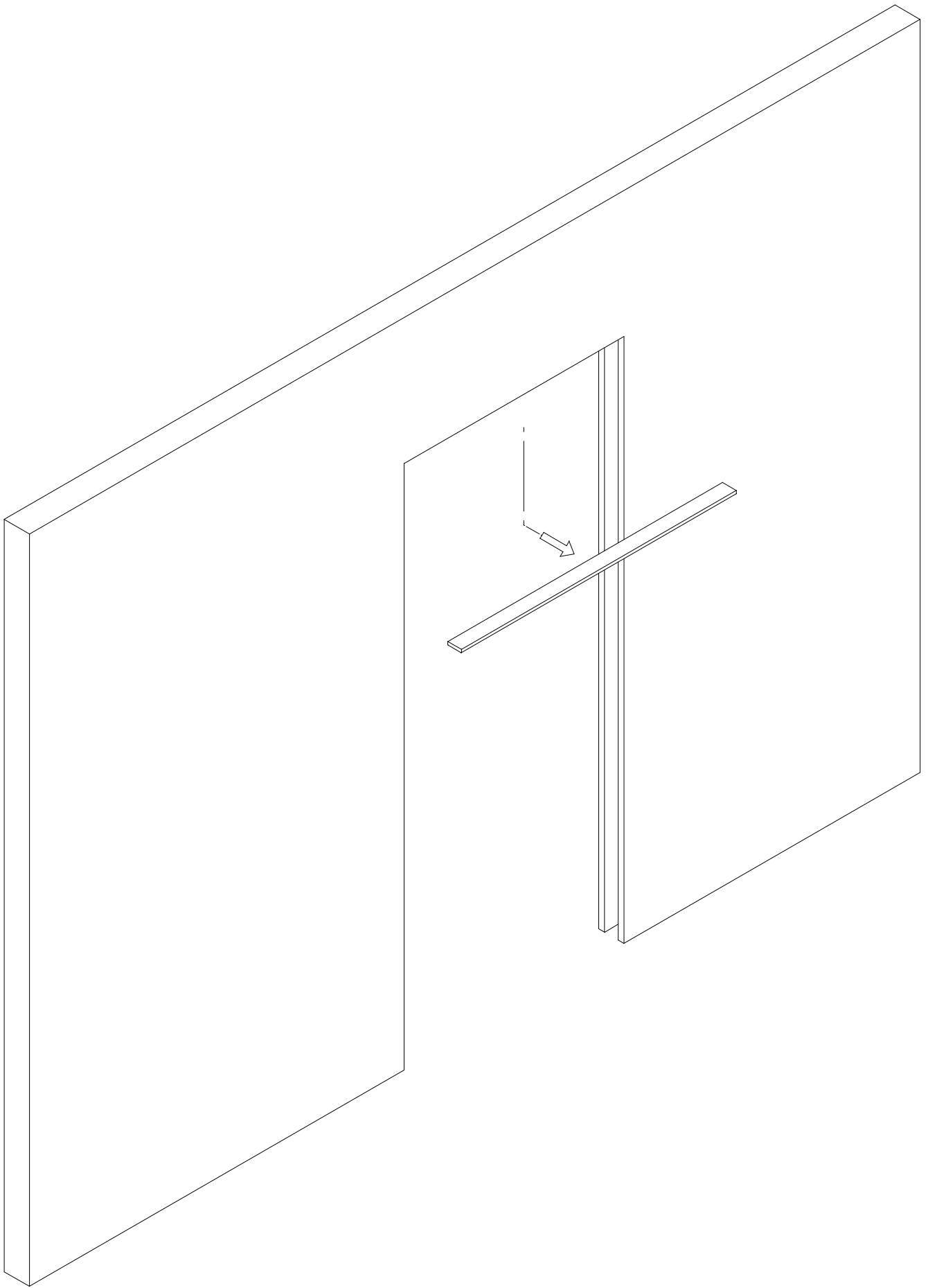

RIMOZIONE POLISTIROLO
PROTEZIONE BINARIO

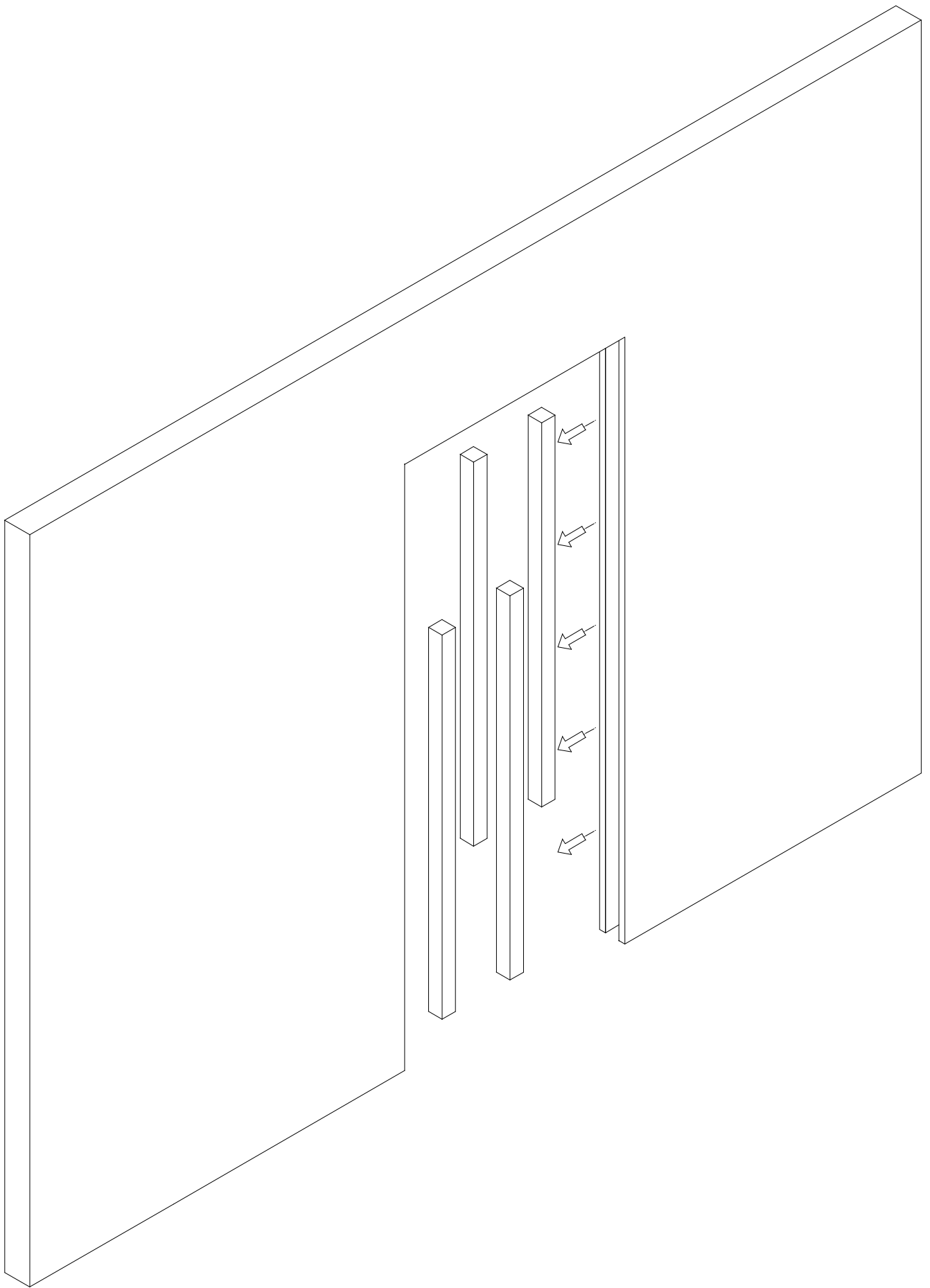

RIMOZIONE POLISTIROLI
INSERITI NEL CASSONE

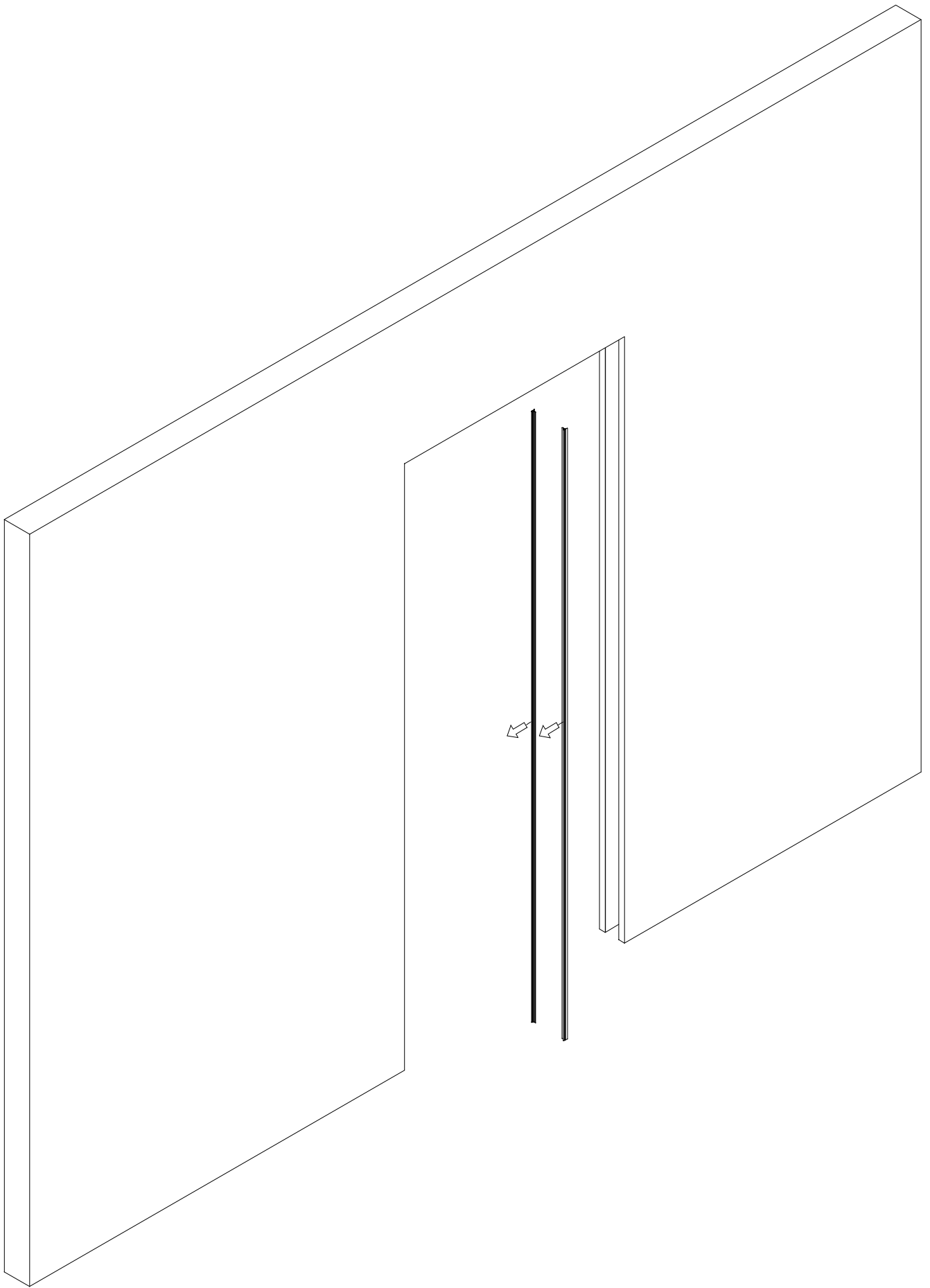

MONTAGGIO GUARNIZIONI

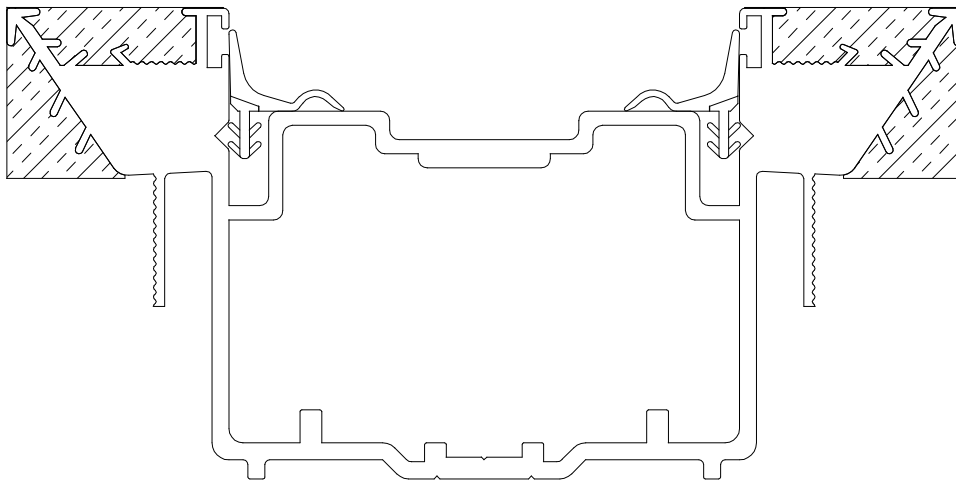
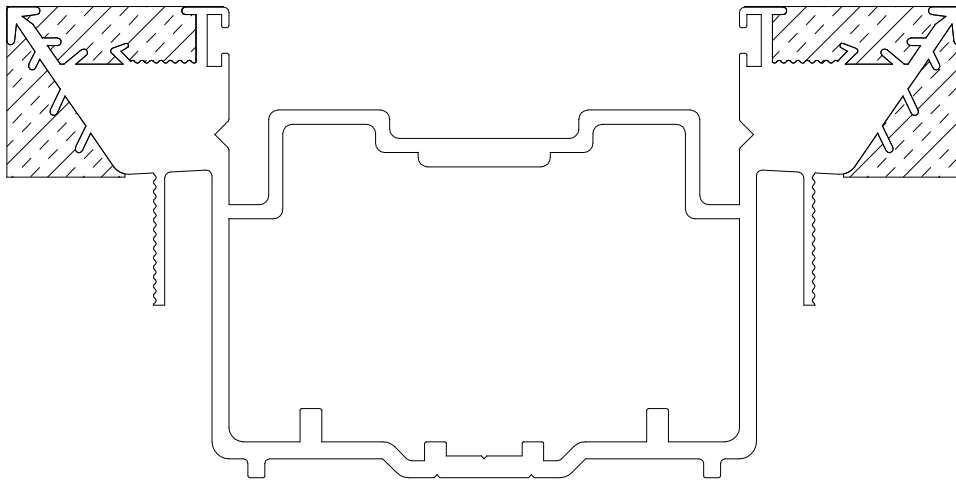
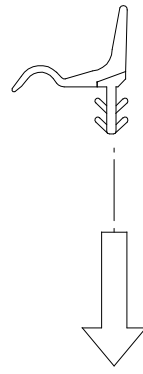
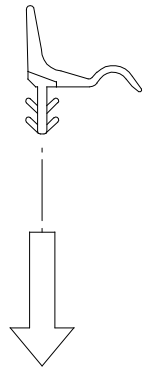

PARTICOLARE MONTAGGIO GUARNIZIONI

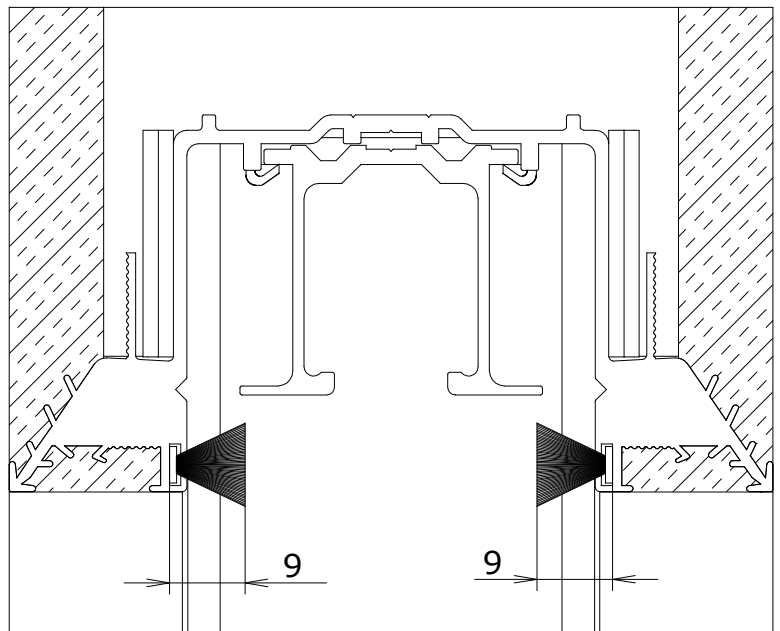
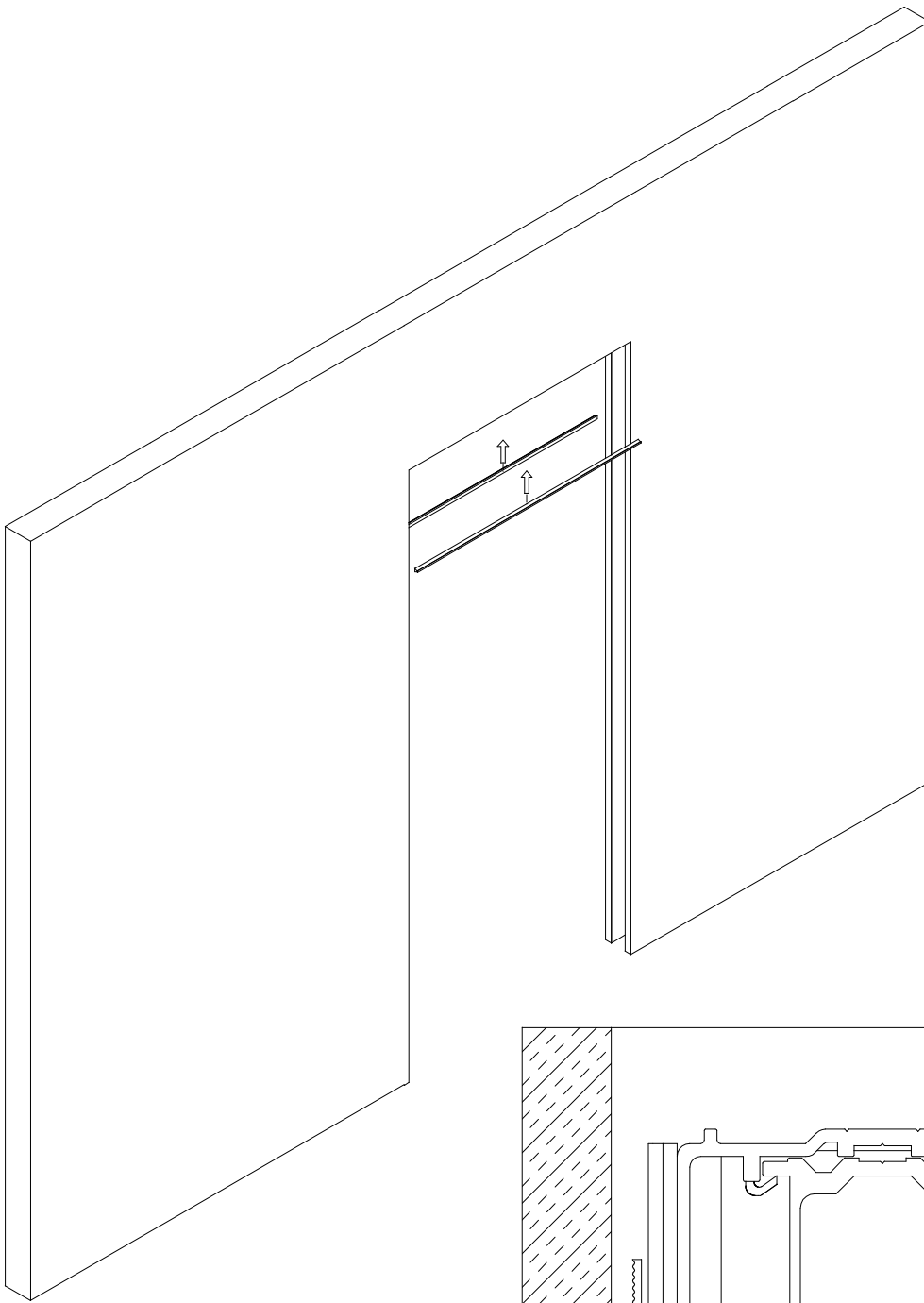

MONTAGGIO SPAZZOLINO TRAVERSA

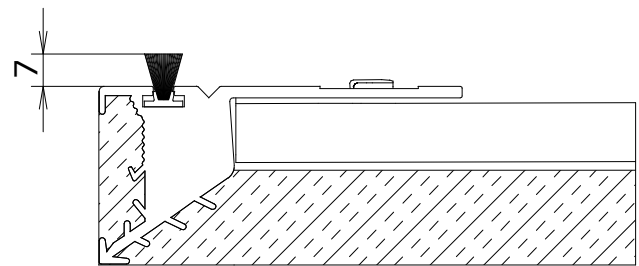
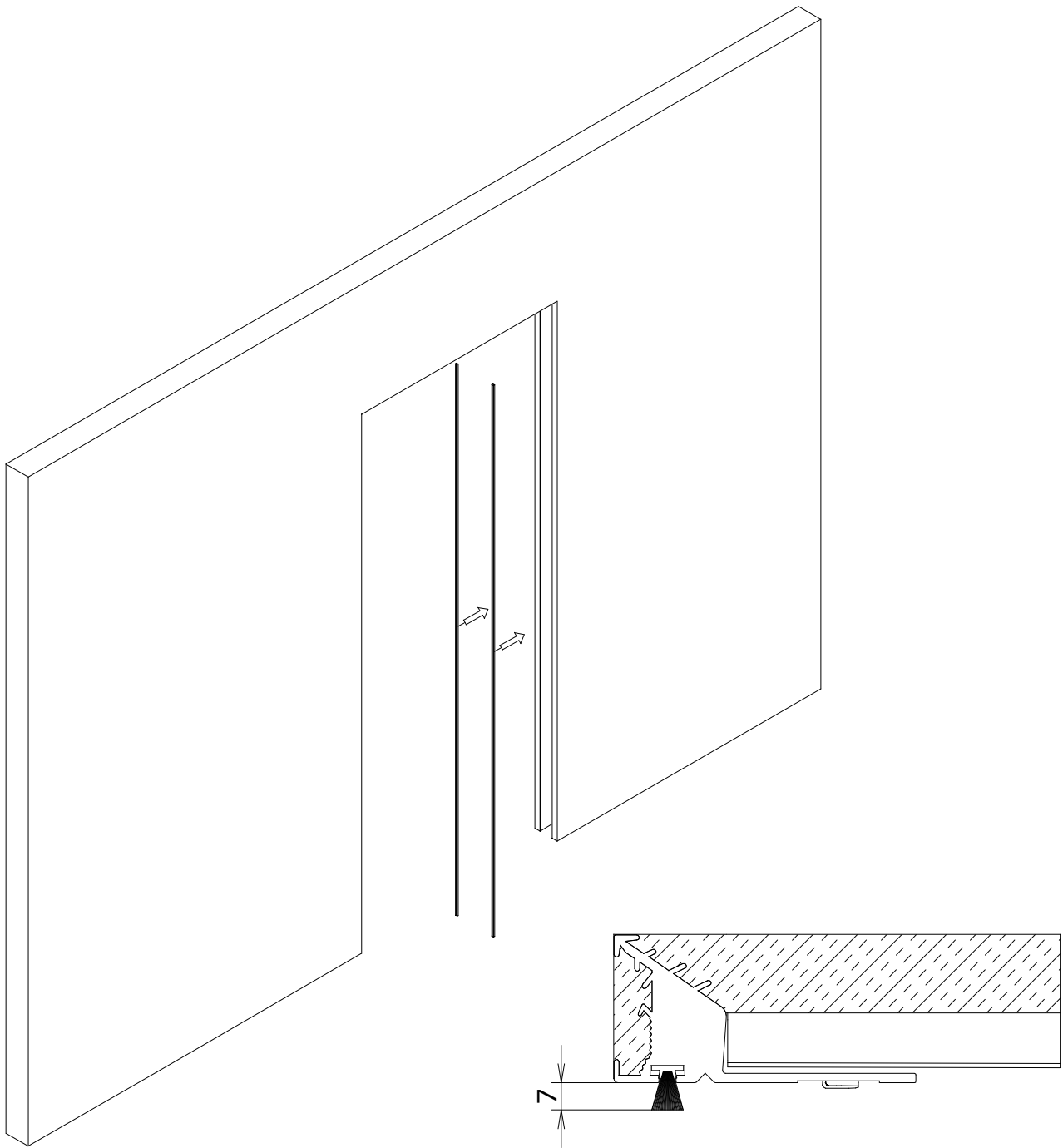

MONTAGGIO SPAZZOLINI
MONTANTI ANTERIORI

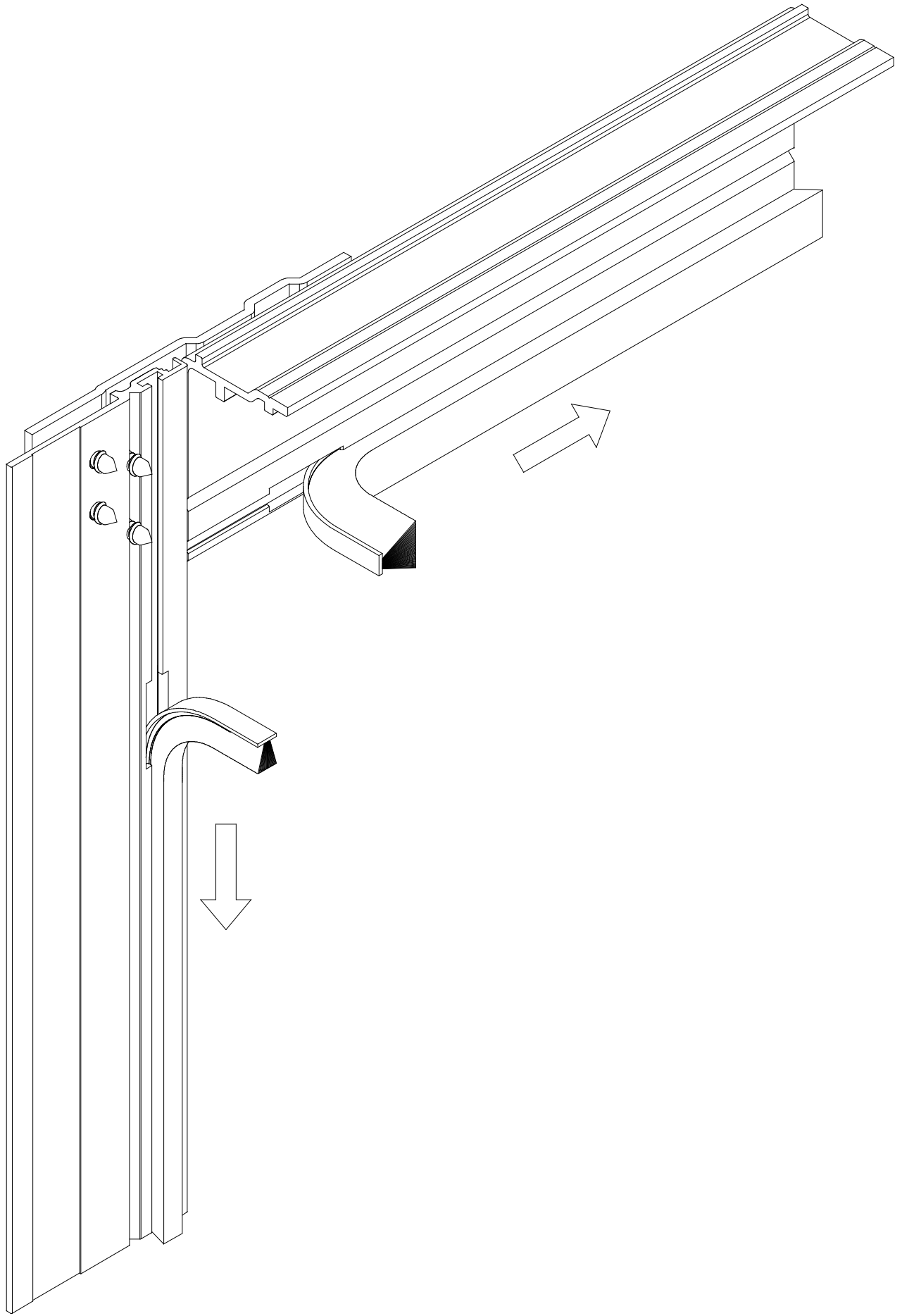

INSERIMENTO SPAZZOLINI
TRAVERSA + MONTANTI

La ditta si riserva la possibilità di apportare le modifiche tecniche che riterrà del caso, senza preavviso. Il presente disegno è di esclusiva proprietà dell'ECLISSE s.r.l. e non può essere duplicato senza autorizzazione della stessa.



ECLISSE[®]
Controtelai per porte a scomparsa

ECLISSE s.r.l. Via Sernaglia, 76
31053 Pieve di Soligo (TV)
Tel.0438 980513 - Fax.0438 980804
eclisse@eclisse.it - www.eclisse.it